



erhältlich ab September 2009!

"HANA-AMI" FLOWER LOOM

SIMPLE & FUN! Use with ribbon, yarn, fabric and more!

Different sizes and shapes! 3 round, 2 square, 1 hexagon



Art No. 3146
"HANA-AMI"
FLOWER LOOM

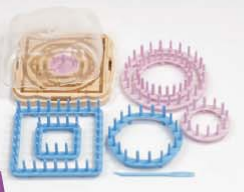

Easy to use loom shapes make flowers ready for use in round, square, and hexagonal designs.

How to use

Just wind the yarn around the outer pegs, and then weave the petals together.

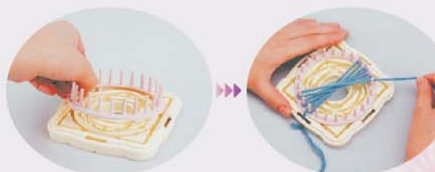

Set the loom on the base.

Wind the yarn around the pegs in a criss-cross fashion.



Weave the yarn around each petal to make a center.



And you've got a flower!

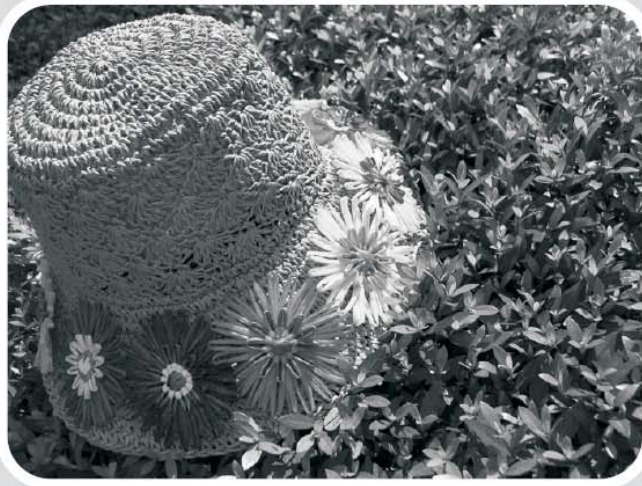

How to make:

1. Make the number of flowers you will need to cover the item to decorate.
* The items above have been given a double-layered flower motif in raffia.
2. Apply the finished flowers with a glue gun or fabric adhesive to complete the decoration.

erhältlich ab September 2009!

Round Loom + Round Loom

Double-Layered Flower Pattern

Place 2 different sized looms on the base. Wind a flower on outer loom first.

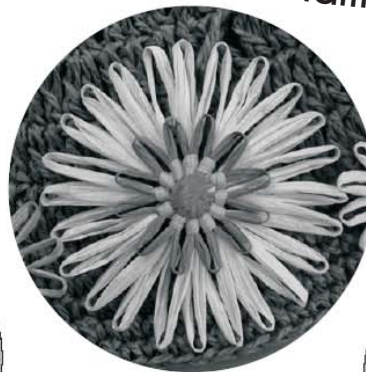
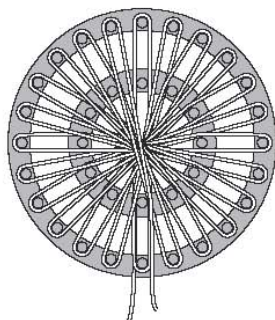

Wind smaller flower on inner loom. Finally, darn small flower to larger flower.

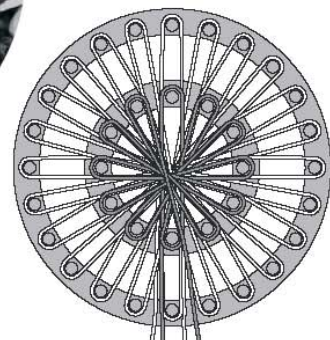

● Back Stitching

Flower Pattern: use the backstitch to darn.

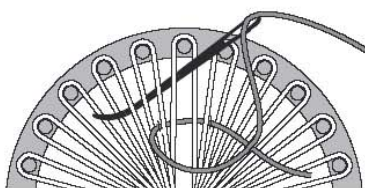

Scoop up 4 strands, then go 2 strands back to start the next stitch.

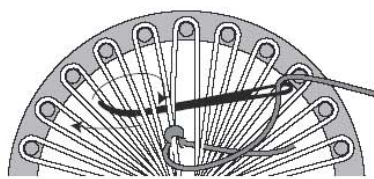

Stitch a full circle, keeping each stitch tight and pushed toward center.

Fasten Yarn:

Tie ends of the yarn together on the reverse side of the flower; tuck ends in darning stitches and trim.